

1L PUMP BOTTLE TROUBLESHOOTING/MAINTENANCE

Hints for use:

- Fill the bottle as far as maximum level indicator. Use clean liquids, free from solids, to ensure a clean nozzle and fine spray pattern.
- Insert pump assembly and screw tightly so airtight seals can maintain sufficient pressure.
- Action pump using approximately 30 strokes for 0.8 litres, more if tank contains less. By using pump, build adequate pressure dependant on fluid level.
- Press trigger and adjust nozzle for required spray (fine mist ↺ ↻ spray).

Problem	Solution
Plunger not moving – cannot compress.	Pump bottle needs to be oiled where marked. Oil regularly to prevent drying out. (See image 1)
Plunger stiff	Lube plunger rod at base. (See image 1 - "Oil Here")
Pump bottle leaking	<ul style="list-style-type: none"> • Seals may need to be replaced. Purchase seal kit Art No. 0899 599. Replace all seals as per image 2. • Nozzle too tight – loosen. (See image 1) • Neck of bottle too loose – tighten. (See image 1) • Check for damage to o-ring (See image 2 - No. 2). O-ring needs to be replaced if damaged.
General care	Air pressure needs to be released from bottle when in storage. (See image 1)
Warranty	No warranty is issued for use with non-Wurth products – seals may perish using non-Wurth products.

Image 1 - Maintenance

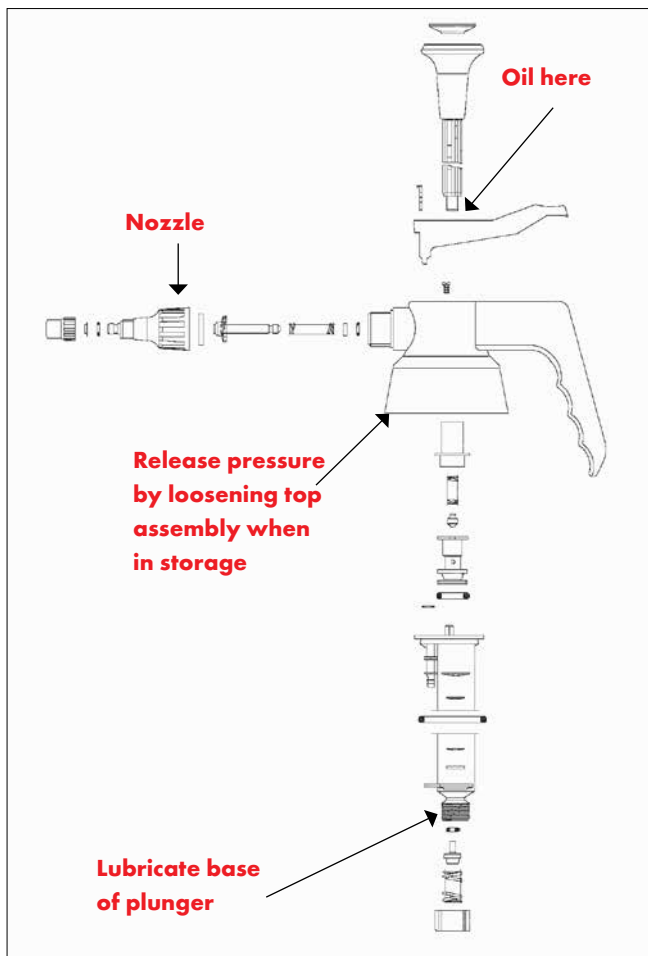

Image 2 - O-Ring Assembly

